

Dumbwaiter

- ▶ Dumbwaiters are small freight elevators (or lifts) intended to carry objects rather than people.
- ▶ Dumbwaiters found within modern structures, including both commercial, public and private buildings are often connected between multiple floors. When installed in restaurants, schools, kindergartens, hospitals, retirement homes or in private homes, the lifts generally terminate in a kitchen.
- ▶ The term seems to have been popularized in the United States in the 1840s, after the model of earlier "dumbwaiters" now know as serving trays and lazy Susans.



Dumbwaiter Drum Type Machine



Dumbwaiter Pulley Type Machine

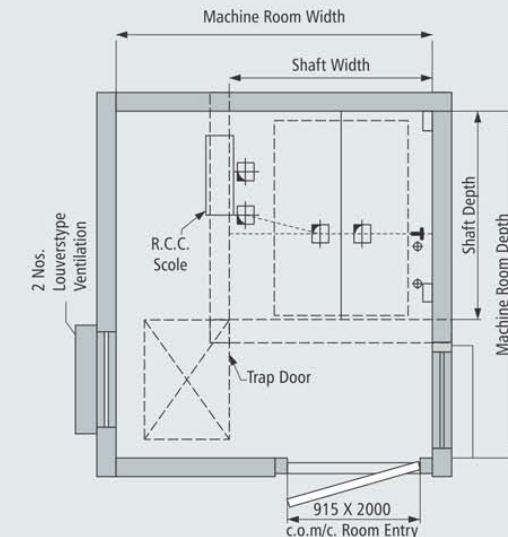

Cross Sectional Machine Room Plan

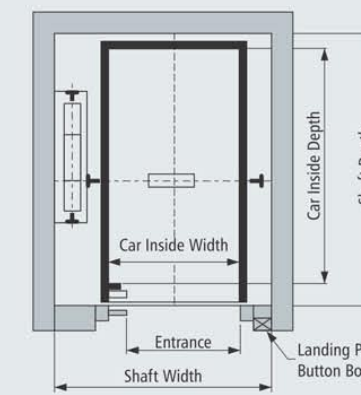

Cross Sectional Lift Shaft Plan Stretcher Lift (manual Door)

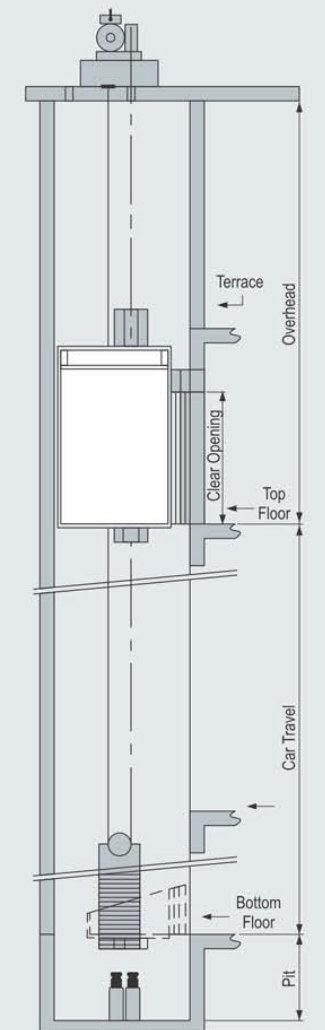

Sectional Elevation of Elevator

Capacity	Shaft - W	Shaft - D	Car - W	Car - D
Kg.	A	B	C	D
200	1200	1300	800	800
300	1350	1450	850	900
400	1500	1500	1000	1000
500	1600	1550	1100	1000

• All Dimension are in mm. • This is General Data, it may be changed without notice. • All hoist way walls should be minimum 230 mm brick or 150 mm R. C. C.